



# PRESTANCE

Maisons de ville | Plessis & Panet

## MODÈLE A.1

RUE PANET

UNITÉ : 10 - 12

SUPERFICIE : 2579 PI<sup>2</sup>

TERRASSE ARRIÈRE : 305 PI<sup>2</sup>

TERRASSE ÉTAGE 3 : 108 PI<sup>2</sup>

CHAMBRE (S) : 3

SALLE DE BAIN : 2

SALLE D'EAU : 1

PRIX : \_\_\_\_\_

FRAIS DE COPROPRIÉTÉ : \_\_\_\_\_

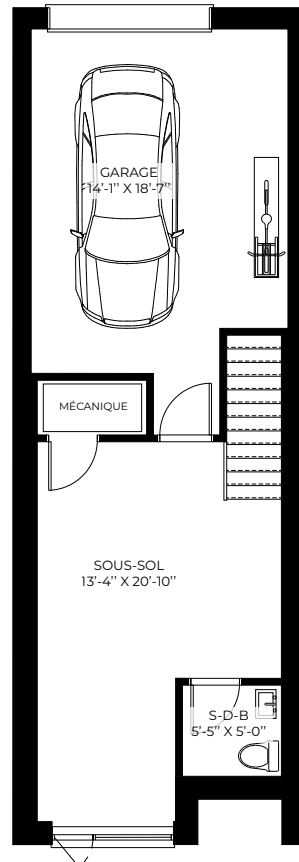

Sous-sol (679 pi<sup>2</sup>)

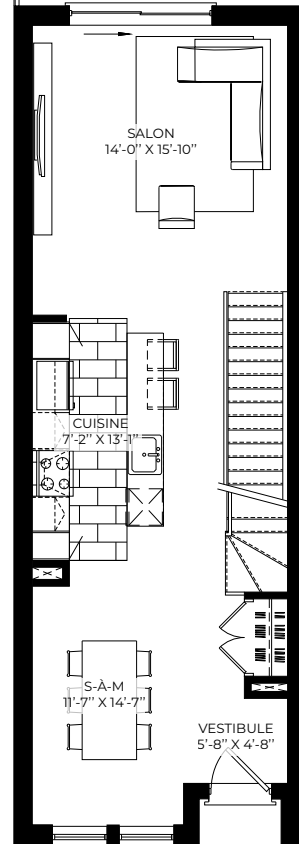

Rez-de-chausée (675 pi<sup>2</sup>)

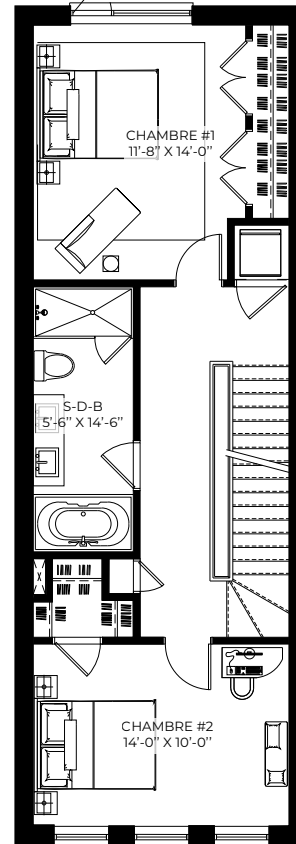

Étage 2 (690 pi<sup>2</sup>)

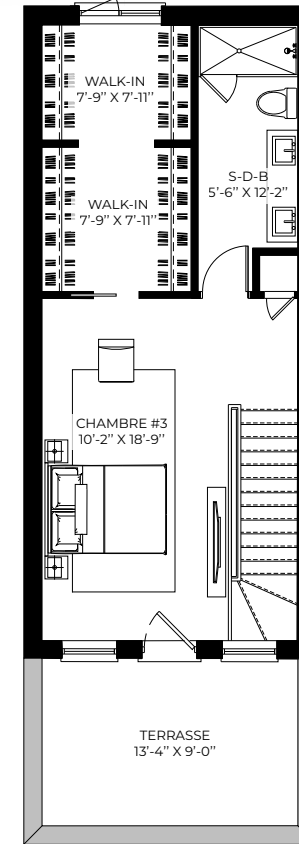

Option 1  
Étage 3 (535 pi<sup>2</sup>)

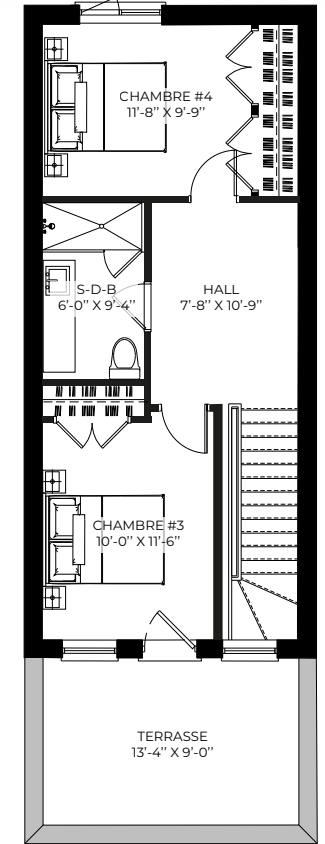

Option 2  
Étage 3 (535 pi<sup>2</sup>)

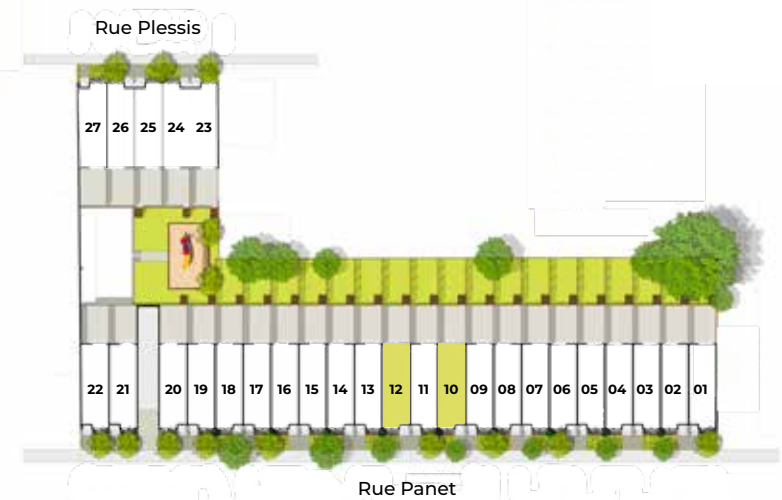
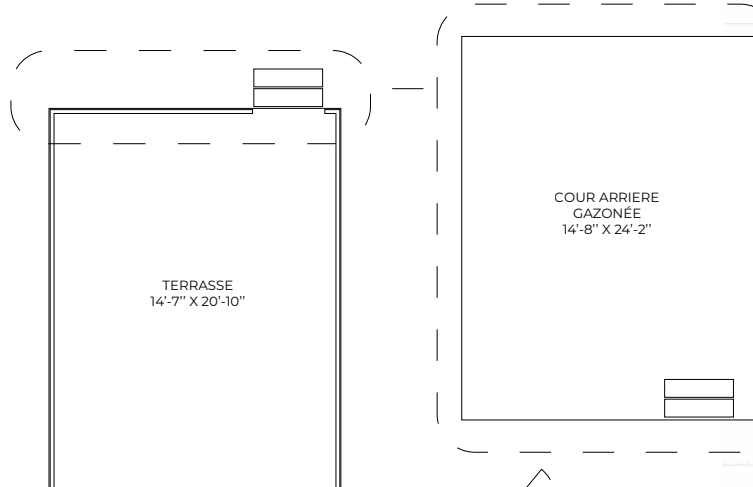

| INITIALES |              |              |
|-----------|--------------|--------------|
| VENDEUR   | ACHETEUR (1) | ACHETEUR (2) |
|           |              |              |